



TECHNICAL DATA

DIESEL GENERATING SET

MPMC POWERTECH CORP.

50HZ

MCS810S-1 / MCS810-1

Features

- Compact structure with high-strength chassis;
- Easy operation and maintenance, Low cost;
- Excellent performance damping system;
- Compliance with international electrical safety standards of electrical system;
- High-performance maintenance-free batteries with isolation switch
- 50°C Radiator;
- Top lifting, Forklift bottom hole design, easy to transport;
- Industrial muffler;
- Noise reduction structure , Low noise;
- Convenient power output interface;
- IP56 (control system)
- Customized design for user
- Structure optional: Open (MCS810-1)
- Sound-proof (MCS810S-1)

Reference images, the actual shall prevail

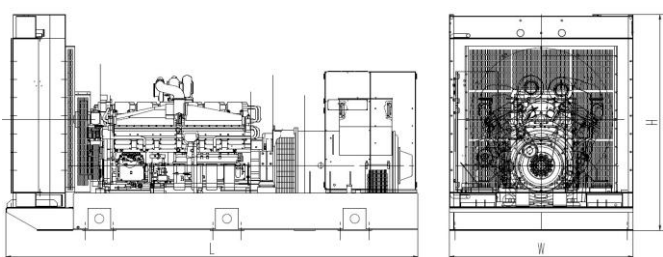
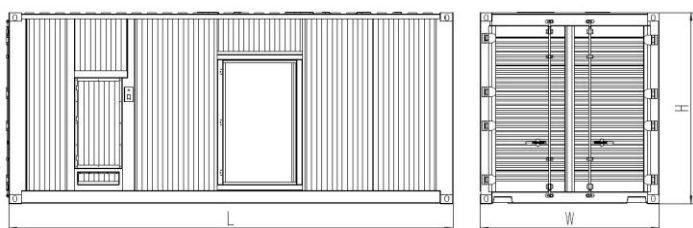

Genset Technical Data

Output frequency	50 HZ
Rated speed	1500 rpm
Prime power	810 KVA
Standby power	891 KVA
Rated voltage	400 V
Phase	3
Noise dB(A) @7m	70
Engine model	KTA38-G2B
Alternator model	HCI 634G
Fuel consumption of 100% load	173 Litres/h
Fuel consumption of 75% load	133 Litres/h
Voltage regulation rate	≤±1%
Random voltage variation	≤±1%
Frequency regulation rate	≤±5%
Random frequency variation	≤±0.5%

Dimension and Weight

Generating set model	MCS810S-1	MCS810-1
Length(L) (mm)	20'GP Container	4200
Width(W) (mm)	20'GP Container	1750
Height(H) (mm)	20'GP Container	2420
Dry weight (k g)	8900	6750
Tank capacity (L)	N.A.	N.A.

Engine Specifications

Engine model	KTA38-G2B
Engine manufacturer	Cummins
Number of cylinders	12
Cylinder arrangement	60° Vee
Cycle	Four stroke
Aspiration	turbo-charged & after-cooled
Bore Stroke (mm mm)	159 x 159
Displacement (Liter)	38
Compression Ratio	14.5:1
Prime power/speed (kW/RPM)	711 /1500rpm
Standby power/speed (kW/RPM)	789 /1500rpm
Speed governor	Electrical
Cooling system	Forced Water Cooling Cycle
Steady speed droop (%)	≤1%
Total lubrication system capacity (L)	135.1
Coolant capacity (L)	123.8
Fuel consumption at 100% load (g/kWh)	204(at 1500RPM)
Starter motor	DC24V
Alternator	DC24V

Alternator Specifications

Rated frequency	50 Hz
Rated speed	1500 rpm
Alternator model	HCI 634G
Rated output prime power	810kVA
Efficiency (%)	94.4%
Phase	3
Rated voltage	400 V
Exciter type	Separated excited by P.M.G, Brushless
Power factor	0.8
Voltage adjust range	≥5.0%
Voltage regulation NL-FL	≤±1.0%
Insulation grade	H
Protection grade	IP23
Xd DIR. AXIS SYNCHRONOUS	2.83
X'd DIR. AXIS TRANSIENT	0.23
X''d DIR. AXIS SUBTRANSIENT	0.16
Xq QUAD. AXIS REACTANCE	1.70
X''q QUAD. AXIS SUBTRANSIENT	0.19

Optional

Optional Alternator brand	Leroy Somer	mecc alte	MPMC
Optional Alternator model	LSA 49.1 M75	ECO43-1SN/4	LYG 404C
Exciter type	Self-excited	Self-excited	Self-excited
Rated output prime power	800KVA	800KVA	800KVA

Control System

NA1-2000-7320 (Optional)

NSM-100-7320 is an advanced control module based on micro-processor, It is an Auto Mains (Utility) Failure Control Module(AMF), have been designed to start and stop generating sets that include electronic And non-electronic engines. Include the additional capability of being able to monitor a mains (utility) supply. when main is not available, It can automatically start the engine and close generating sets breaker automatically, Accurately measure various operational parameters and display all values and alarms information on the LCD. In additional, it can automatically open breaker, and shutdown the engine after the main supply recovers.

Main Features

- AMF and ATS and communication and expansion function
- Designed to work with electronic or non-electronic or gas engine simultaneously. (support many kinds of engines ECU).
- Manual, Automatic, Test and remote control mode selectable.
- Monitoring and measuring operational parameters of the mains supply and genset.
- Indicating operation status, fault conditions, all parameters and alarms
- Multiple protections and multiple parameters display.
- Includes 12 inputs and eight outputs. 8 inputs are configurable and 4 outputs are configurable.
- Can be programmed using the front panel or by using the PC software.
- Support twelve languages. The language was edited by customer.
- Graded protection: pre-alarm, shutdown and electrical trip, flexible setting.
- The module can be pre-set for four operating modes and protecting parameters.
- Add DSE860 or DSE865 module, internet network monitoring can be realized.
- The firmware can be updated automatically, so customer can have the latest version.



The control module display

- Generator voltage
- Generator frequency
- Battery voltage
- Engine speed
- Load current
- Generator KVA, KW, PF
- Engine run-time Hours
- Engine oil pressure
- Engine coolant temperature
- Real time clock for time and date, overall runtime

Optional

Engine

- Water Jacket Preheater
- Fuel-water separator
- Oil pump
- Oil preheater
- Battery preheater

Alternator

- PMG excitation
- Space heater
- Winding Temperature Measuring

Generator Set

- Tools with the machine
- Coolant (-30°C)

Control System

- AMF function
- ATS control cabinet
- Double-frequency and double voltage
- Single phase
- ABB MCCB

Fuel System

- 12 / 24 hour base tank (single wall)
- Dual wall base fuel tank
- Outside fuel tank
- Automatic fuel feeding
- Fuel level indicate

Canopy

- Hired type
- Economy Oil heater
- Trailer

Contact Us

MPMC POWERTECH CORP.

Add: No. 111 Luda Rd., Luyuan Industrial Zone, Pudong Shanghai China

Tel: +86 21 60970158 Fax: +86 21 60970155

Mobile: +86-18621857018 (Robert)

E mail : sales@mpmc-china.com

Web site : www.mpmc-china.com



MPMC reserves the right to make changes in model, technical specification, color, configuration and accessories without prior notice.

Please contact the salesman before ordering.

DISTRIBUTED BY:

© 2013 by MPMC, All right reserved.



ISO9001:2008
MPMC Generating Sets

